

OPERATING MANUAL

Crius C400 with Indirect Lighting - Basic On/Off

Important: Please read the instruction manual carefully prior to installation and keep it for future reference.

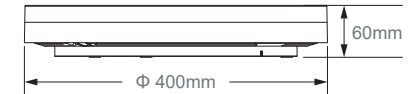

Order Code	Product Series	Power	Function Description
C400 32 000-IND	Crius C400	32W	Basic On/Off

Mounting: Wall or Ceiling

Light features:

Ra: >80

Life Time: 5 years

Light Source: LED SMD2835

Input: 220V-240V 50/60Hz

Accessories

No.	Pic	Qty.	Usage
1		3	Fix light
2		3	Rawl plug
3		3	Plastic washer
4		2	Cable clip
5		4	Fix cable clip

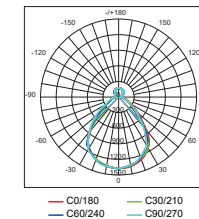

Installation

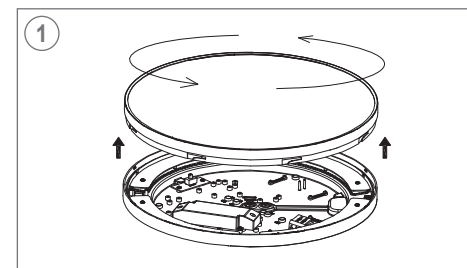

1. Twist the diffuser anticlockwise. Vertically remove the diffuser and PCBA.

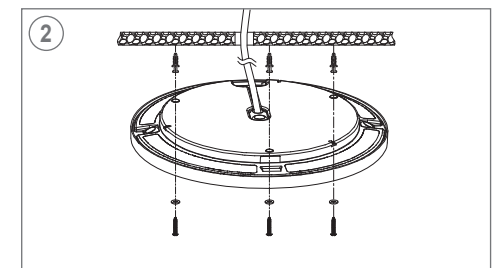

2. a. Cut off the power. Thread the input cable through the rubber plug to the fixture. Connect the wire referring to the wiring diagram.
b. Knock the rawl plugs into the pre-drilled holes on ceiling/wall. Wear plastic washers on self-tapping screws and tighten them to fix the fixture on ceiling/wall.

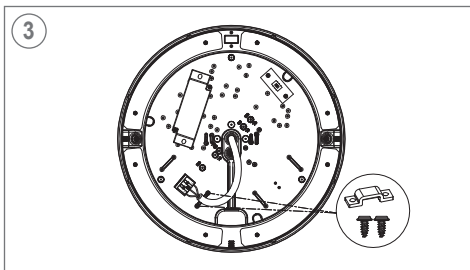

Install the cable clip.

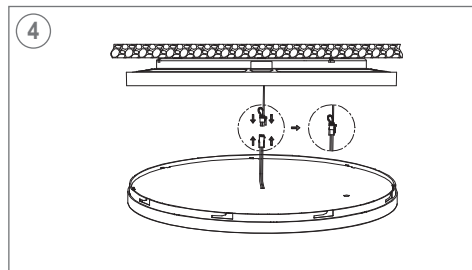

Connect the DC cable.

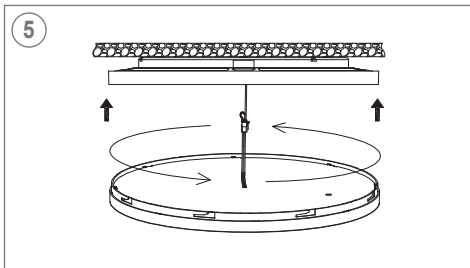

Mount the diffuser onto the base by twisting clockwise.

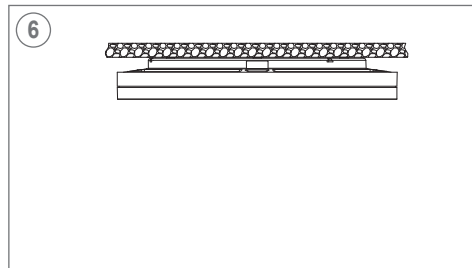

Installation finished.

Caution

1. The product must be installed by professional technicians and power supply must be cut off before installation.
2. The diameter for AC input wire is 0.75mm² (complying with 60245 IEC57), which complies with the latest IEE electrical standards or national standards.
3. Do not touch the electronic circuit and its components.
4. Contact an authorised technical service centre for any repairs possibly required use only original spare parts.
5. Do not touch LED while installing or maintaining.
6. Sealing the entrance hole with glue after install is needed.
7. The light source contained in this luminaire shall only be replaced by the manufacturer or his service agent or a similar qualified person.

Wiring

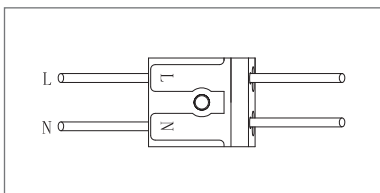

Maintenance

1. Cut off the main power first.
2. Don't touch LEDs while maintaining or cleaning.
3. Don't use chemicals to clean the fixture.



Environmental protection: waste electrical products should not be disposed of with household waste. Please recycle where facilities exist. Check with your local authority or retailer for recycling advice.

